

# PRODUCT CATALOGUE

RUBBER PADS | RUBBER BLOCKS  
RUBBER PLATES | SPECIAL EQUIPMENT  
for automotive lifts

# CONTENT

---



RUBBER PADS

PAGE 4

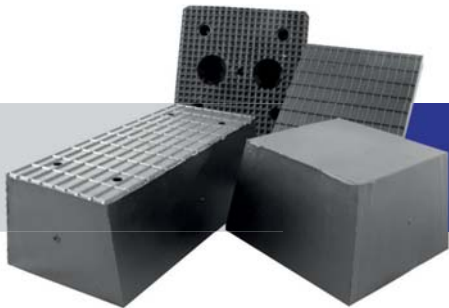

RUBBER BLOCKS

PAGE 18

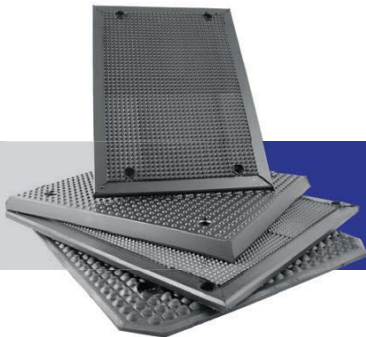

RUBBER PLATES

PAGE 23



SPECIAL EQUIPMENT

PAGE 26

All images in this print media are subject to copyright and can only be used with permission. We reserve the right to change product specifications without prior notification.  
Technical changes and errors expected. (V.17-01)

---

# **LIFTING UP SAFELY**



# RUBBER PADS



ord.nr.: 015

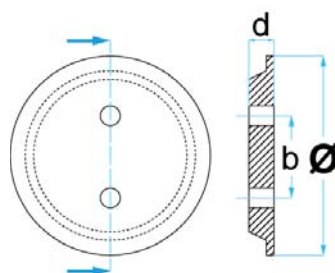

suitable for:  
J.A.B. BECKER

$\text{Ø} = 115 \text{ mm}$

$b = 73 \text{ mm}$

$d = 20 \text{ mm}$

0,25 kg



ord.nr.: 024481

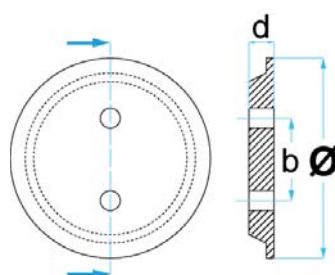

suitable for:  
J.A.B. BECKER

$\text{Ø} = 120 \text{ mm}$

$b = 75 \text{ mm}$

$d = 21 \text{ mm}$

0,15 kg



ord.nr.: 169100MET

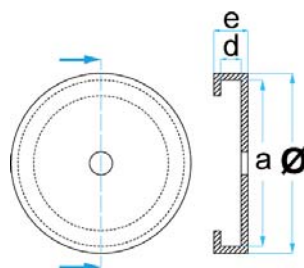

with steel plate

suitable for:  
J.A.B. BECKER /  
ATH / HOFMANN /  
HERRMANN

$\text{Ø} = 120 \text{ mm}$

$a = 110 \text{ mm}$

$d = 4 \text{ mm}$

$e = 16 \text{ mm}$

0,29 kg



ord.nr.: 169100

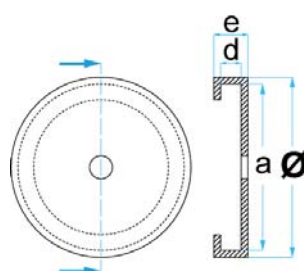

suitable for:  
J.A.B. BECKER /  
ATH / HOFMANN /  
HERRMANN

$\text{Ø} = 120 \text{ mm}$

$a = 110 \text{ mm}$

$d = 4 \text{ mm}$

$e = 16 \text{ mm}$

0,15 kg



ord.nr.: 169130

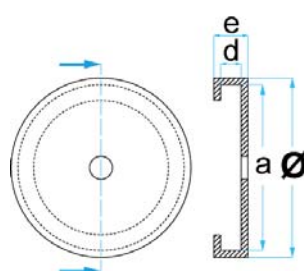

suitable for:  
HERRMANN

$\text{Ø} = 130 \text{ mm}$

$a = 122 \text{ mm}$

$d = 5 \text{ mm}$

$e = 17 \text{ mm}$

0,20 kg

# RUBBER PADS



ord.nr.: 335022

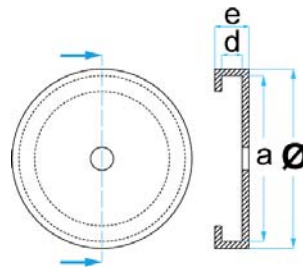

suitable for:  
HOFMANN  
**Ø = 140 mm**  
a = 132 mm  
d = 4 mm  
e = 17 mm  
0,20 kg



ord.nr.: 335160-GS5.0

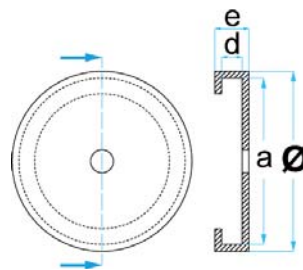

suitable for:  
HOFMANN  
**Ø = 160 mm**  
a = 148 mm  
d = 6 mm  
e = 24 mm  
0,38 kg



ord.nr.: 336000

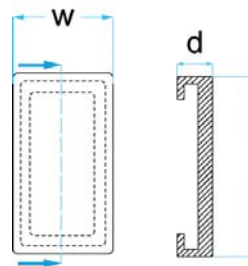

suitable for:  
HOFMANN  
d = 25 mm  
w = 91 mm  
l = 162 mm  
0,24 kg



ord.nr.: 01103031

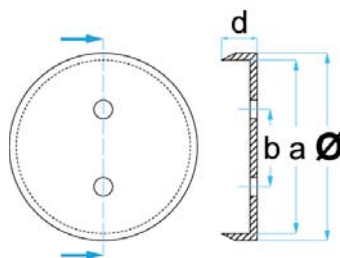

with steel plate

suitable for:  
NUSSBAUM / AMI  
**Ø = 125 mm**  
a = 120 mm  
b = 90 mm  
d = 24 mm  
0,30 kg



ord.nr.: GK125/120

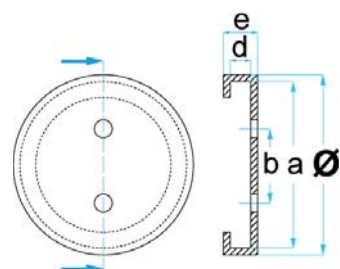

with steel plate

suitable for:  
SLIFT / IME  
**Ø = 127 mm**  
a = 120 mm  
b = 83 mm  
d = 9 mm  
e = 28 mm  
0,35 kg

# RUBBER PADS



ord.nr.: GK155/16

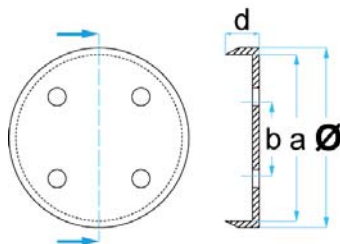

with steel plate

suitable for:  
SLIFT / IME

**Ø = 155 mm**

a = 153 mm

b = 85 mm

d = 16 mm

0,30 kg



ord.nr.: GK122/12

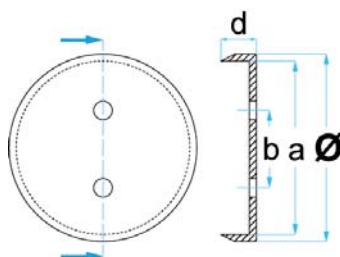

with steel plate

suitable for:  
SLIFT / IME

**Ø = 122 mm**

a = 116 mm

b = 80 mm

d = 12 mm

0,15 kg



ord.nr.: 36001.04.04.001

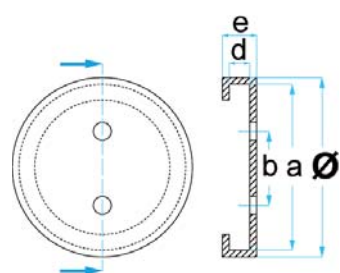

suitable for:  
MAHA / SLIFT

**Ø = 120 mm**

a = 112 mm

b = 83 mm

d = 5 mm

e = 18 mm

0,15 kg



ord.nr.: 115172024

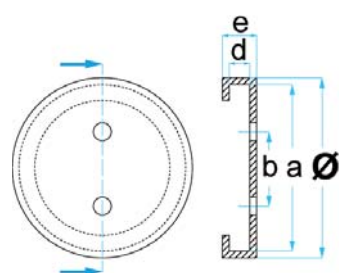

suitable for:  
MAHA / SLIFT

**Ø = 100 mm**

a = 90 mm

b = 63 mm

d = 5 mm

e = 17,5 mm

0,10 kg



ord.nr.: 17202301MET

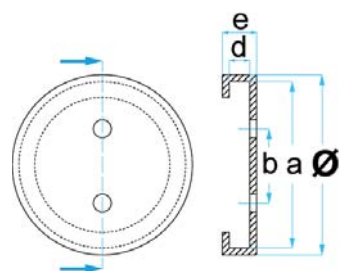

with steel plate

suitable for:  
MAHA

**Ø = 120 mm**

a = 113 mm

b = 83 mm

d = 8 mm

e = 22 mm

0,26 kg

# RUBBER PADS



ord.nr.: 17202301

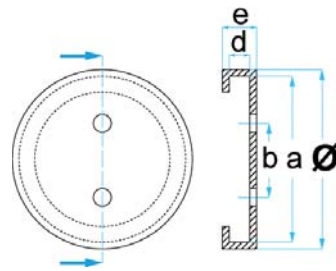

suitable for:  
MAHA

$\varnothing = 120 \text{ mm}$   
 $a = 113 \text{ mm}$   
 $b = 83 \text{ mm}$   
 $d = 8 \text{ mm}$   
 $e = 22 \text{ mm}$   
 0,15 kg



ord.nr.: 121KP6Z215

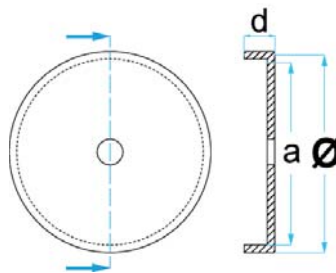

suitable for:  
RAVAGLIOLI

$\varnothing = 144 \text{ mm}$   
 $a = 117 \text{ mm}$   
 $d = 20 \text{ mm}$   
 0,30 kg



ord.nr.: 047021040

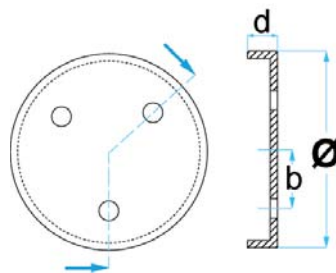

suitable for:  
RAVAGLIOLI

$\varnothing = 145 \text{ mm}$   
 $b = 45 \text{ mm}$   
 $d = 26 \text{ mm}$   
 0,30 kg



ord.nr.: 04640577

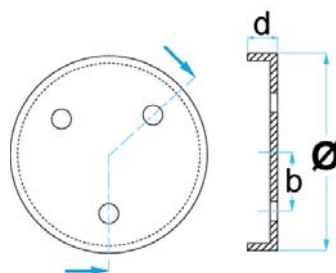

suitable for:  
RAVAGLIOLI

$\varnothing = 120 \text{ mm}$   
 $b = 36 \text{ mm}$   
 $d = 27 \text{ mm}$   
 0,25 kg



ord.nr.: 046405772MET

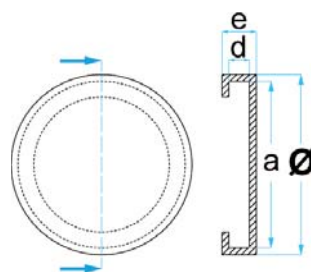

with steel plate

suitable for:  
RAVAGLIOLI /  
WERTHER

$\varnothing = 123 \text{ mm}$   
 $a = 110 \text{ mm}$   
 $d = 10 \text{ mm}$   
 $e = 25 \text{ mm}$   
 0,30 kg

# RUBBER PADS



ord.nr.: 046405772

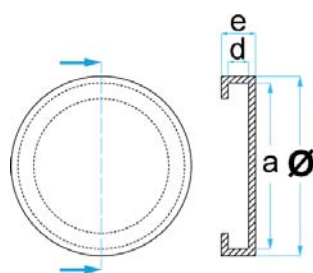

suitable for:  
RAVAGLIOLI /  
WERTHER

**Ø = 123 mm**

a = 110 mm

d = 10 mm

e = 25 mm

0,15 kg



ord.nr.: 047021850MET

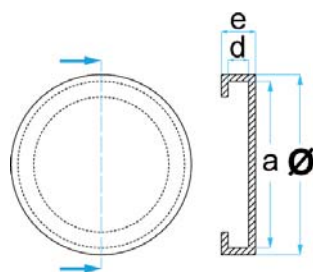

with steel plate

suitable for:  
RAVAGLIOLI / SIRIO /  
SPACE

**Ø = 100 mm**

a = 87 mm

d = 9 mm

e = 21 mm

0,17 kg



ord.nr.: 047021850

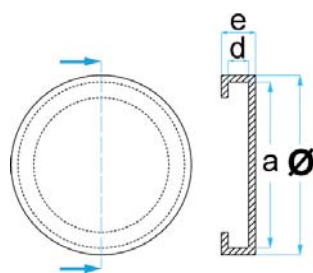

suitable for:  
RAVAGLIOLI / SIRIO /  
SPACE

**Ø = 100 mm**

a = 87 mm

d = 9 mm

e = 21 mm

0,10 kg



ord.nr.: 047021041

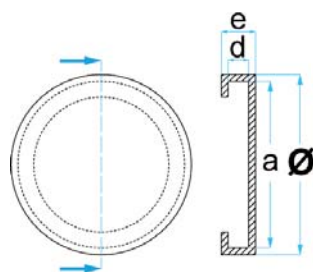

suitable for:  
RAVAGLIOLI

**Ø = 148 mm**

a = 133 mm

d = 10 mm

e = 25 mm

0,26 kg



ord.nr.: OMCN-140

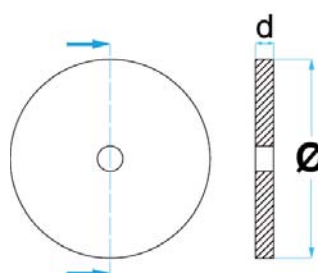

suitable for:  
OMCN

**Ø = 143 mm**

d = 27 mm

0,35 kg



# RUBBER PADS



ord.nr.: OMCN-140-002

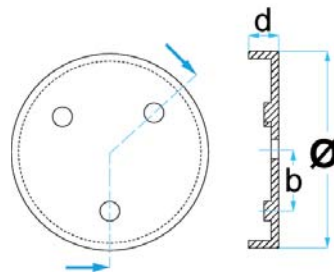

suitable for:  
OMCN  
**Ø = 140 mm**  
b = 42 mm  
d = 29 mm  
0,31 kg



ord.nr.: WERTHER002

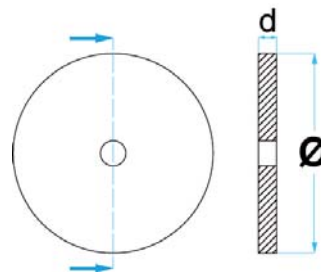

suitable for:  
WERTHER / OMA  
/ BRADBURY /  
TECALEMIT / AUTECH  
**Ø = 140 mm**  
d = 15 mm  
0,25 kg



ord.nr.: WERTHER001-B1007

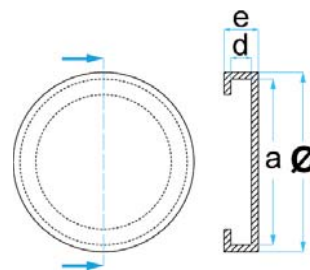

suitable for:  
WERTHER / OMA /  
TECALEMIT  
**Ø = 122 mm**  
a = 114 mm  
d = 10 mm  
e = 28 mm  
0,23 kg



ord.nr.: 15.87.425

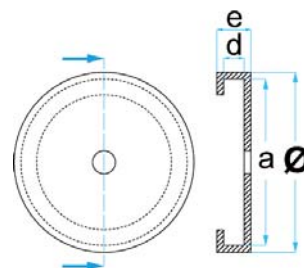

suitable for:  
ZIPPO / FOG  
**Ø = 127 mm**  
a = 123 mm  
d = 8 mm  
e = 22 mm  
0,15 kg



ord.nr.: 15.87.410

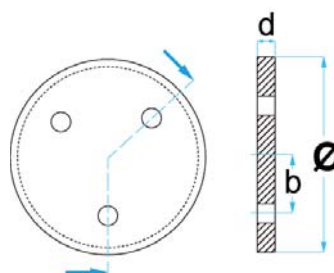

with steel plate

suitable for:  
ZIPPO  
**Ø = 100 mm**  
b = 35 mm  
d = 17 mm  
0,24 kg

# RUBBER PADS



ord.nr.: 15.87.420

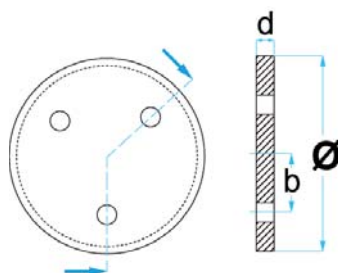

with steel plate

suitable for:  
ZIPPO

$\text{Ø} = 120 \text{ mm}$

$b = 44 \text{ mm}$

$d = 16 \text{ mm}$

0,30 kg



ord.nr.: 15.87.450

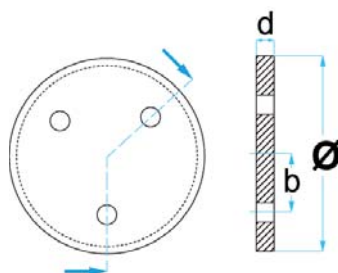

with steel plate

suitable for:  
ZIPPO

$\text{Ø} = 149 \text{ mm}$

$b = 105 \text{ mm}$

$d = 15 \text{ mm}$

0,75 kg



ord.nr.: 15.87.453

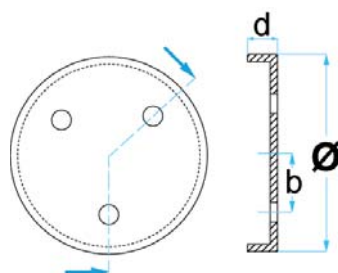

with steel plate

suitable for:  
ZIPPO

$\text{Ø} = 153 \text{ mm}$

$b = 102 \text{ mm}$

$d = 32 \text{ mm}$

0,75 kg



ord.nr.: 02-CONSUL

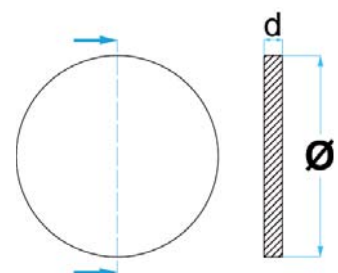

with steel plate

suitable for:  
CONSUL

$\text{Ø} = 138 \text{ mm}$

$d = 18 \text{ mm}$

0,75 kg



ord.nr.: 02-CONSUL-01

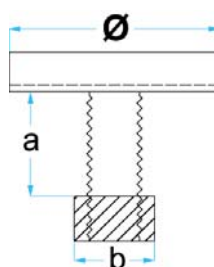

complete rotating plate

suitable for:  
CONSUL

$\text{Ø} = 135 \text{ mm}$

$a = 32 \text{ mm}$

$b = 40 \text{ mm}$

1,40 kg

# RUBBER PADS



ord.nr.: 02-CONSUL-01-CA

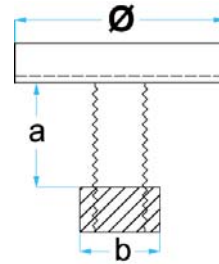

rotating plate incl. changeable rubber pad

suitable for:  
CONSUL / ZIPPO

**Ø = 135 mm**

a = 32 mm

b = 40 mm

1,50 kg



ord.nr.: 02-CONSUL-01-GTRP

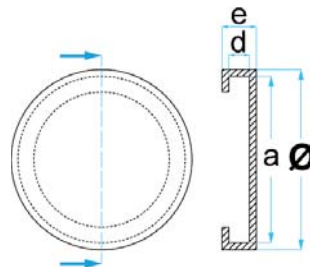

with steel plate

suitable for:  
CONSUL / ZIPPO

**Ø = 135 mm**

a = 129 mm

d = 8 mm

e = 10 mm

0,30 kg



ord.nr.: 664202

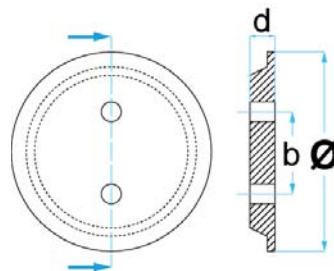

with steel plate

suitable for:  
STENHOJ / AUTOP /  
FOG / CAR-O-LINER

**Ø = 121 mm**

b = 65 mm

d = 9 mm

0,20 kg



ord.nr.: 664000

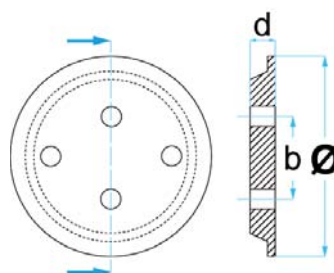

with steel plate

suitable for:  
STENHOJ / NUSSBAUM  
/ AUTOP / FOG / CAR-O-  
LINER

**Ø = 122 mm**

b = 65 / 88 mm

d = 18 mm

0,18 kg



ord.nr.: 664160

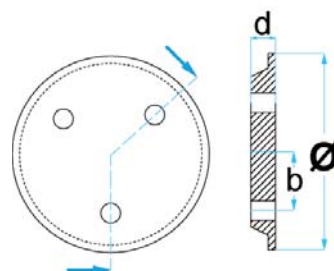

suitable for:  
STENHOJ

**Ø = 158 mm**

b = 47 mm

d = 11 mm

0,40 kg

# RUBBER PADS



ord.nr.: SK2030-105

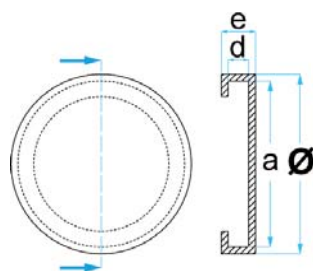

suitable for:  
KONI / BRADBURY  
/ HERKULES /  
TECALEMIT

**Ø = 105 mm**  
a = 100 mm  
d = 10 mm  
e = 26 mm  
0,15 kg



ord.nr.: SK2030-124

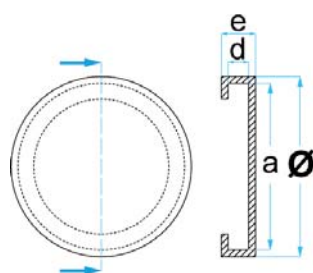

suitable for:  
KONI

**Ø = 124 mm**  
a = 118 mm  
d = 5 mm  
e = 17 mm  
0,16 kg



ord.nr.: SK2030-160

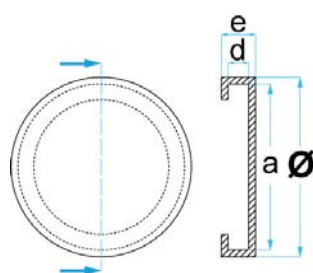

suitable for:  
KONI / ROMEICO / CAR-  
O-LINER

**Ø = 160 mm**  
a = 153 mm  
d = 10 mm  
e = 28 mm  
0,33 kg



ord.nr.: ROMEICO124

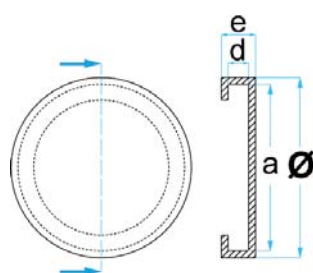

suitable for:  
ROMEICO / HH  
INTERTECH / CORGHI

**Ø = 124 mm**  
a = 116 mm  
d = 10 mm  
e = 22 mm  
0,15 kg



ord.nr.: ROTARY

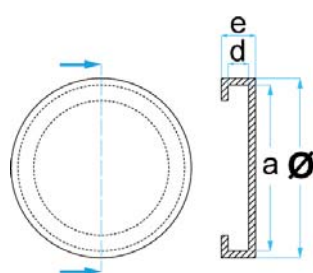

suitable for:  
ROTARY

**Ø = 123 mm**  
a = 112 mm  
d = 8 mm  
e = 20 mm  
0,20 kg

# RUBBER PADS



ord.nr.: ROTARY-FJRP

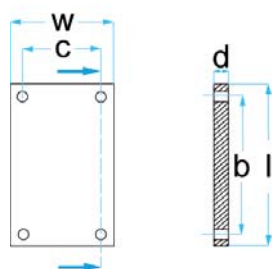

valido para:  
**ROTARY**  
 b = 80 mm  
 c = 56 mm  
 d = 8 mm  
 w = 82 mm  
 l = 104 mm  
 0,12 kg



ord.nr.: ZAV-41-113

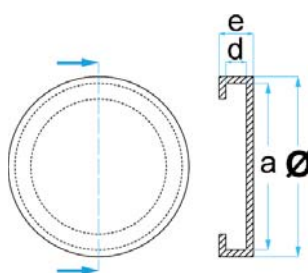

suitable for:  
**EUROLIFT / ORLANDINI**  
**Ø = 128 mm**  
 a = 112 mm  
 d = 8 mm  
 e = 22 mm  
 0,20 kg



ord.nr.: IST0720300

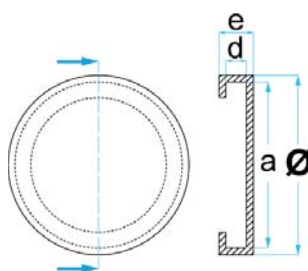

suitable for:  
**ISTOBAL / VELYEN**  
**Ø = 155 mm**  
 a = 147 mm  
 d = 6 mm  
 e = 24 mm  
 0,27 kg



ord.nr.: IST1304800

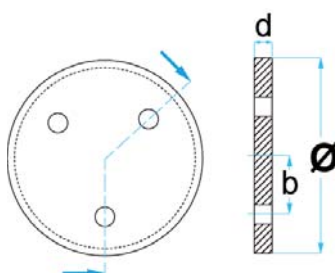

suitable for:  
**ISTOBAL / VELYEN**  
**Ø = 145 mm**  
 b = 60 mm  
 d = 5 mm  
 0,10 kg



ord.nr.: LAUNCH120

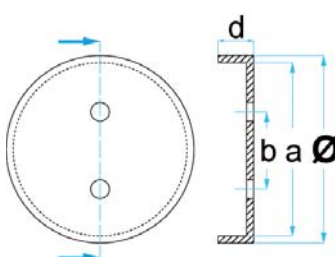

suitable for:  
**LAUNCH / TWIN BUSCH / RP TOOLS**  
**Ø = 120 mm**  
 a = 108 mm  
 b = 69 mm  
 d = 32 mm  
 0,30 kg

# RUBBER PADS



ord.nr.: AGM139

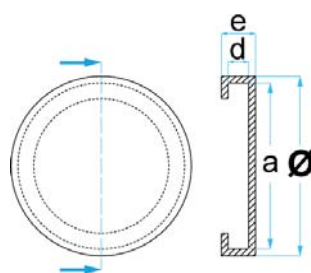

suitable for:  
AGM / CORGHI / FOG

**Ø = 139 mm**

a = 130 mm

d = 8 mm

e = 28 mm

0,30 kg



ord.nr.: CASCOS001

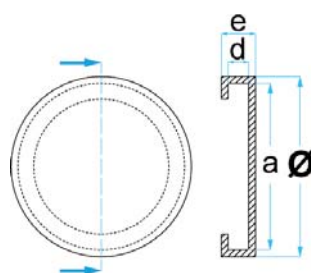

suitable for:  
CASCOS

**Ø = 138 mm**

a = 130 mm

d = 8 mm

e = 21 mm

0,26 kg



ord.nr.: BRADBURY001

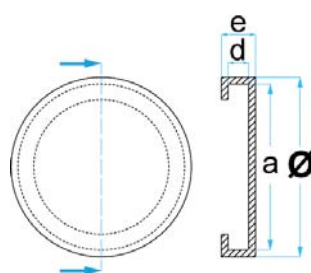

suitable for:  
BRADBURY

**Ø = 158 mm**

a = 148 mm

d = 11 mm

e = 27 mm

0,37 kg



ord.nr.: BRADBURY002

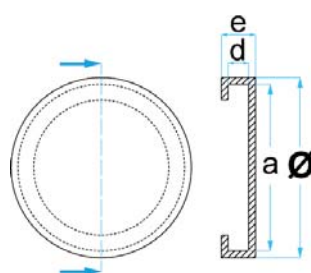

suitable for:  
BRADBURY

**Ø = 150 mm**

a = 142 mm

d = 7 mm

e = 22 mm

0,21 kg



ord.nr.: RANGER001

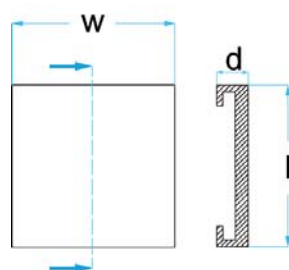

suitable for:  
BENDPAK / RANGER

d = 32 mm

w = 143 mm

l = 143 mm

0,50 kg

# RUBBER PADS



ord.nr.: BENDPAK002

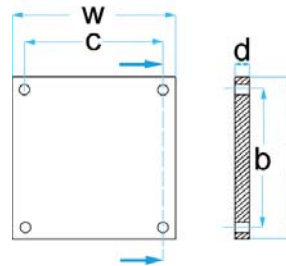

suitable for:  
BENDPAK  
b = 88 mm  
c = 88 mm  
d = 12 mm  
w = 119 mm  
l = 119 mm  
0,20 kg



ord.nr.: LAYCOCK001

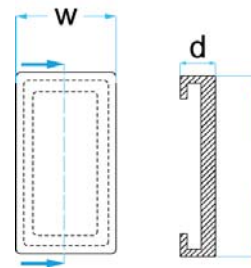

suitable for:  
LAYCOCK / KISMET  
d = 28 mm  
w = 80 mm  
l = 150 mm  
0,27 kg



ord.nr.: SILENT001

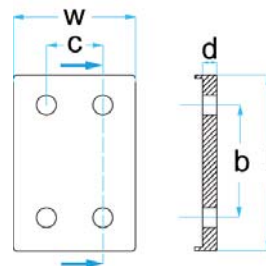

suitable for:  
SILENT  
b = 60 mm  
c = 40 mm  
d = 20 mm  
w = 83 mm  
l = 118 mm  
0,27 kg



ord.nr.: SILENT001MET

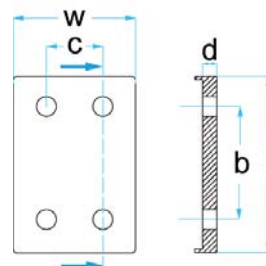

with steel plate

suitable for:  
SILENT  
b = 60 mm  
c = 40 mm  
d = 20 mm  
w = 83 mm  
l = 118 mm  
0,35 kg



ord.nr.: HPOW001

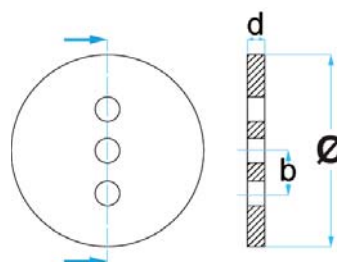

suitable for:  
POWERREX /  
HESHBON  
**Ø = 120 mm**  
b = 25 mm  
d = 17 mm  
0,21 kg

# RUBBER PADS



ord.nr.: HPOW002

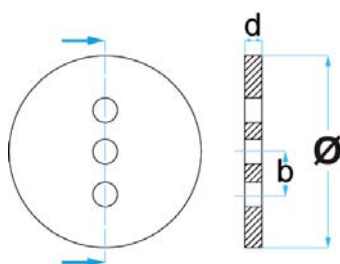

suitable for:  
POWERREX /  
HESHBON / ROTARY

**Ø = 120 mm**  
b = 25 mm  
d = 25 mm  
0,32 kg



ord.nr.: BISHAMON001

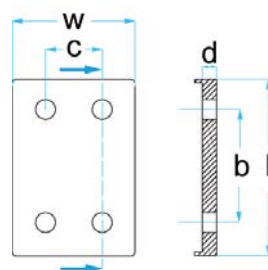

with steel plate

suitable for:  
BISHAMON

b = 74 mm  
c = 40 mm  
d = 20 mm  
w = 80 mm  
l = 116 mm  
0,28 kg



ord.nr.: BISHAMON002

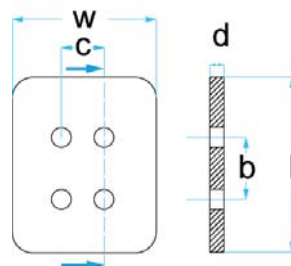

with steel plate

suitable for:  
BISHAMON

b = 45 mm  
c = 40 mm  
d = 16 mm  
w = 92 mm  
l = 112 mm  
0,31 kg



ord.nr.: GTCN001

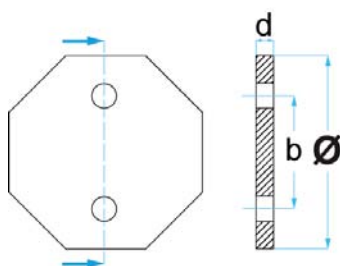

suitable for:  
many chinese  
manufactured lifts

**Ø = 125 mm**  
b = 90 mm  
d = 10 mm  
0,17 kg



ord.nr.: NORDLIFT17200

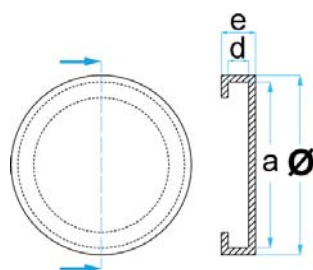

suitable for:  
NORDLIFT

**Ø = 127 mm**  
a = 115 mm  
d = 7 mm  
e = 23 mm  
0,17 kg



# RUBBER PADS



ord.nr.: 149950

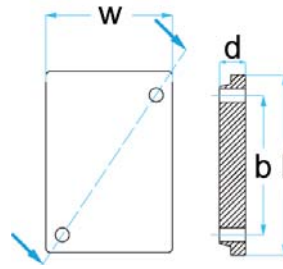

suitable for:  
J.A.B. BECKER  
b = 73 mm  
d = 18 mm  
w = 81 mm  
l = 100 mm  
0,15 kg



ord.nr.: 100100

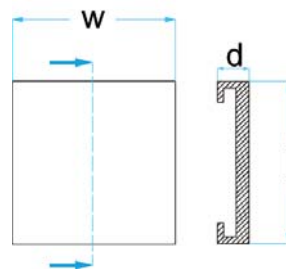

suitable for:  
COMPAQ  
d = 32 mm  
w = 120 mm  
l = 120 mm  
0,18 kg



ord.nr.: AC-GS1

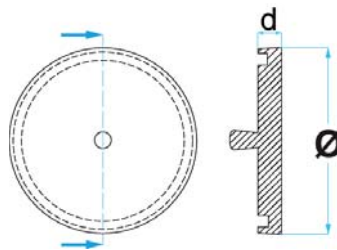

suitable for:  
AC HYDRAULIC  
**Ø = 110 mm**  
d = 20 mm  
0,17 kg



ord.nr.: AC-GS2

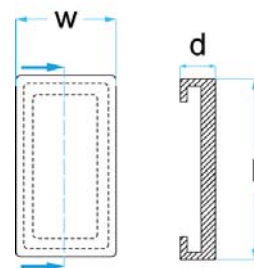

suitable for:  
AC HYDRAULIC / MAHA  
/ ROTARY  
d = 17 mm  
w = 61 mm  
l = 112 mm  
0,15 kg



ord.nr.: COL001

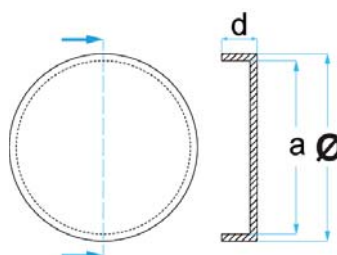

suitable for:  
CAR-O-LINER  
**Ø = 89 mm**  
a = 80 mm  
d = 17 mm  
0,10 kg

# RUBBER BLOCKS

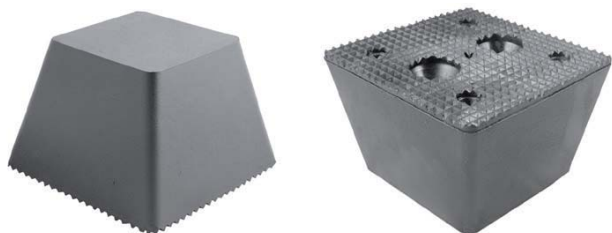

**ord.nr.: 165042**

150 x 150 x 100 mm  
1,90 kg

suitable for:  
J.A.B. BECKER /  
AUTOP / universal use

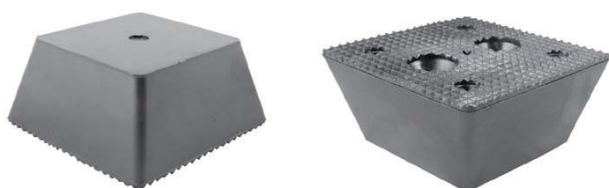

**ord.nr.: 165030**

150 x 150 x 70 mm  
1,40 kg

suitable for:  
J.A.B. BECKER /  
AUTOP / universal use



**ord.nr.: 165036**

150 x 150 x 60 mm  
1,20 kg

suitable for:  
J.A.B. BECKER /  
AUTOP / universal use

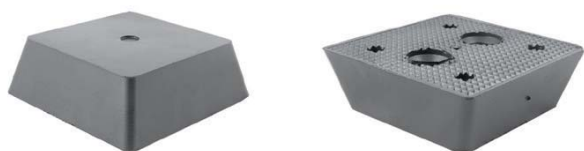

**ord.nr.: 165031**

150 x 150 x 50 mm  
1,10 kg

suitable for:  
J.A.B. BECKER /  
AUTOP / universal use

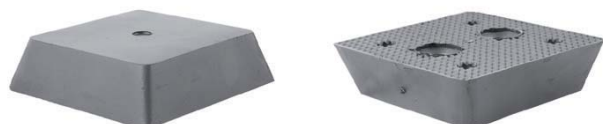

**ord.nr.: 165034**

150 x 150 x 40 mm  
0,80 kg

suitable for:  
J.A.B. BECKER /  
AUTOP / universal use

# RUBBER BLOCKS



**ord.nr.: 165037**

150 x 150 x 30 mm  
0,72 kg

suitable for:  
J.A.B. BECKER /  
AUTOP / universal use



**ord.nr.: 165040**

180 x 100 x 100 mm  
2,10 kg

suitable for:  
universal use

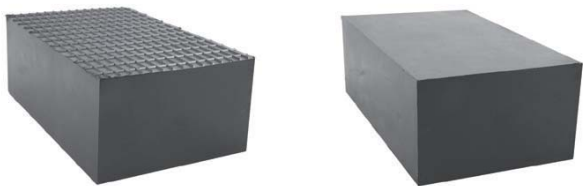

**ord.nr.: 165033H**

220 x 140 x 85 mm  
with wooden core  
2,75 kg

suitable for:  
universal use

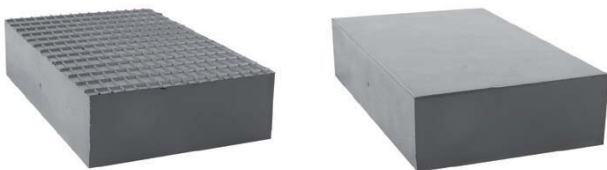

**ord.nr.: 165032**

220 x 140 x 50 mm  
1,80 kg

suitable for:  
universal use



**ord.nr.: 165035**

160 x 120 x 20 mm  
0,60 kg

suitable for:  
J.A.B. BECKER /  
AUTOP / universal use

# RUBBER BLOCKS



**ord.nr.: GK12/8**

120 x 120 x 80 mm  
1,10 kg

suitable for:  
SLIFT / IME / universal  
use



**ord.nr.: 316930**

120 x 100 x 50 mm  
0,55 kg

suitable for:  
MAHA / universal use



**ord.nr.: 38.31.829**

200 x 100 x 40 mm  
0,95 kg

suitable for:  
ZIPPO / universal use



**ord.nr.: 38.31.830**

200 x 100 x 70 mm  
with wooden core  
1,20 kg

suitable for:  
ZIPPO / universal use



**ord.nr.: 38.31.831**

230 x 140 x 120 mm  
with wooden core  
4,60 kg

suitable for:  
ZIPPO / universal use

# RUBBER BLOCKS



**ord.nr.: 38.31.831OLD**

231 x 140 x 120 mm  
with wooden core  
4,60 kg

suitable for:  
ZIPPO / universal use



**ord.nr.: 30100012030**

120 x 100 x 30 mm  
0,45 kg

suitable for:  
HERKULES



**ord.nr.: PE-900-KGK-20**

250 x 150 x 20 mm +/- 5 mm  
0,11 kg

suitable for:  
universal use



**ord.nr.: PE-900WEISS/KLEIN**

340 x 132 x 50 mm +/- 5 mm  
0,35 kg

suitable for:  
universal use



**ord.nr.: PE-900WEISS/GROSS**

340 x 150 x 100 mm +/- 5 mm  
0,75 kg

suitable for:  
universal use

# RUBBER BLOCKS

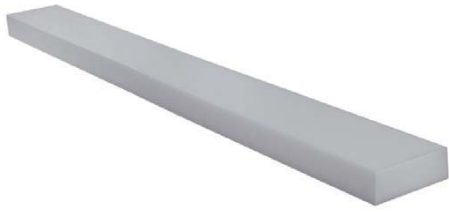

**ord.nr.: PE-900-SH-49**

1355 x 140 x 49 mm +/- 5 mm  
1,45 kg

suitable for:  
universal use



**ord.nr.: PE-900-SH-95**

1355 x 140 x 95 mm +/- 5 mm  
2,80 kg

suitable for:  
universal use

# RUBBER PLATES



**ord.nr.: 165029**

380 x 260 x 13 mm  
2,75 kg

suitable for:  
J.A.B. BECKER



**ord.nr.: GK40/2**

400 x 350 x 16 mm  
3,30 kg  
old version

suitable for:  
SLIFT / IME



**ord.nr.: GK40/12**

400 x 350 x 12 mm  
2,70 kg  
new version

suitable for:  
SLIFT / IME



**ord.nr.: GK53/12**

535 x 350 x 12 mm  
4,20 kg

suitable for:  
SLIFT / IME

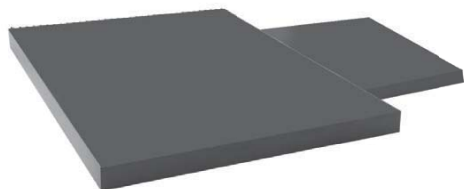

**ord.nr.: GK34/2**

333 x 290 x 20 mm  
2,35 kg

suitable for:  
SLIFT / IME / universal  
use

# RUBBER PLATES



**ord.nr.: GK39/2**

370 x 330 x 20 mm  
2,55 kg

suitable for:  
MAHA / universal use



**ord.nr.: GK45/2**

450 x 450 x 20 mm  
5,70 kg

suitable for:  
MAHA / universal use



**ord.nr.: 37005/BO**

270 x 210 x 20 mm  
1,35 kg

suitable for:  
AUTOP



**ord.nr.: 37006/BO**

400 x 350 x 12 mm  
3,35 kg  
incl. screw connection

suitable for:  
AUTOP



**ord.nr.: 24003**

405 x 305 x 35 mm  
5,75 kg

suitable for:  
AUTOP



# RUBBER PLATES



**ord.nr.: 507176**

220 x 120 x 12 mm  
0,85 kg

suitable for:  
J.A.B BECKER



**ord.nr.: 509281**

220 x 170 x 12 mm  
1,25 kg

suitable for:  
J.A.B BECKER



**ord.nr.: WZ-00931-AO**

150 x 150 x 12 mm  
0,75 kg

suitable for:  
HYWEMA

# SPECIAL EQUIPMENT



**ord.nr.: LIFTADAPTERS80110-130**

incl. GummirondeS80  
suitable on rubber pads with:  
Ø = 110-130 mm  
0,71 kg

suitable for:  
Volvo S80 / universal  
use



**ord.nr.: LIFTADAPTERS80130-160**

incl. GummirondeS80  
suitable on rubber pads with:  
Ø = 130-160 mm  
0,75 kg

suitable for:  
Volvo S80 / universal  
use



**ord.nr.: LIFTBORDS80**

incl. GummirondeS80  
for scissor- and inground lifts  
1,10 kg

suitable for:  
Volvo S80 / universal  
use



**ord.nr.: GUMMIRONDES80**

Ø = 100 mm  
lifting extension  
0,30 kg

suitable for:  
Liftadapter / Liftboard /  
universal use



**ord.nr.: GUMMIRONDE30**

Ø = 100 mm  
lifting extension  
0,35 kg

suitable for:  
Liftadapter / Liftboard /  
universal use

# SPECIAL EQUIPMENT



ord.nr.: **GUMMIRONDE50**

Ø = 100 mm  
lifting extension  
0,54 kg

suitable for:  
Liftadapter / Liftboard /  
universal use



ord.nr.: **T5110-130**

suitable on rubber pads with:  
Ø = 110-130 mm  
0,60 kg

suitable for:  
VW T5 Multivan



ord.nr.: **T5130-160**

suitable on rubber pads with:  
Ø = 130-160 mm  
0,65 kg

suitable for:  
VW T5 Multivan

**LIFTING UP SAFELY**



LATI Trading Co. Ltd.

Leading Auto Tools Importers Larnaca

Telephone: 99101519 | 99041096 | 99286706

Fax: 24669994

E-mail: [latitools@cytanet.com.cy](mailto:latitools@cytanet.com.cy)